



# Key features of the Hargrave-Andrew Library refurbishment – Floor-by-floor



## Making a grand entrance...

The entrance to the library will be relocated to create a pleasant destination that makes the most of the Hargrave Café and substantially improves access for people with a disability.



## Ground Floor

- Express terminals for accessing the library catalogue and resources
- Improved quiet study areas utilising shelving to buffer noise
- Improved layout of large journal collection allowing for more intuitive navigation
- Centrally-located photocoppy area
- Casual seating areas allowing for browsing and quiet discussion



## Level One

- 70 computer workstations featuring flat screen monitors for increased work space
- A new 'open reserve' area, allowing self-service access to high-use materials, with photocopiers and express terminals
- Information point featuring large screen to convey temporary and urgent messages to library users
- Dual-purpose training room with larger desks allowing for group study at computers supplying an additional 20 computer workstations when not required for training
- Four high-speed printers and a colour printer
- Express terminals for accessing the library catalogue and resources
- New and improved housing for the Map Collection
- More group study facilities

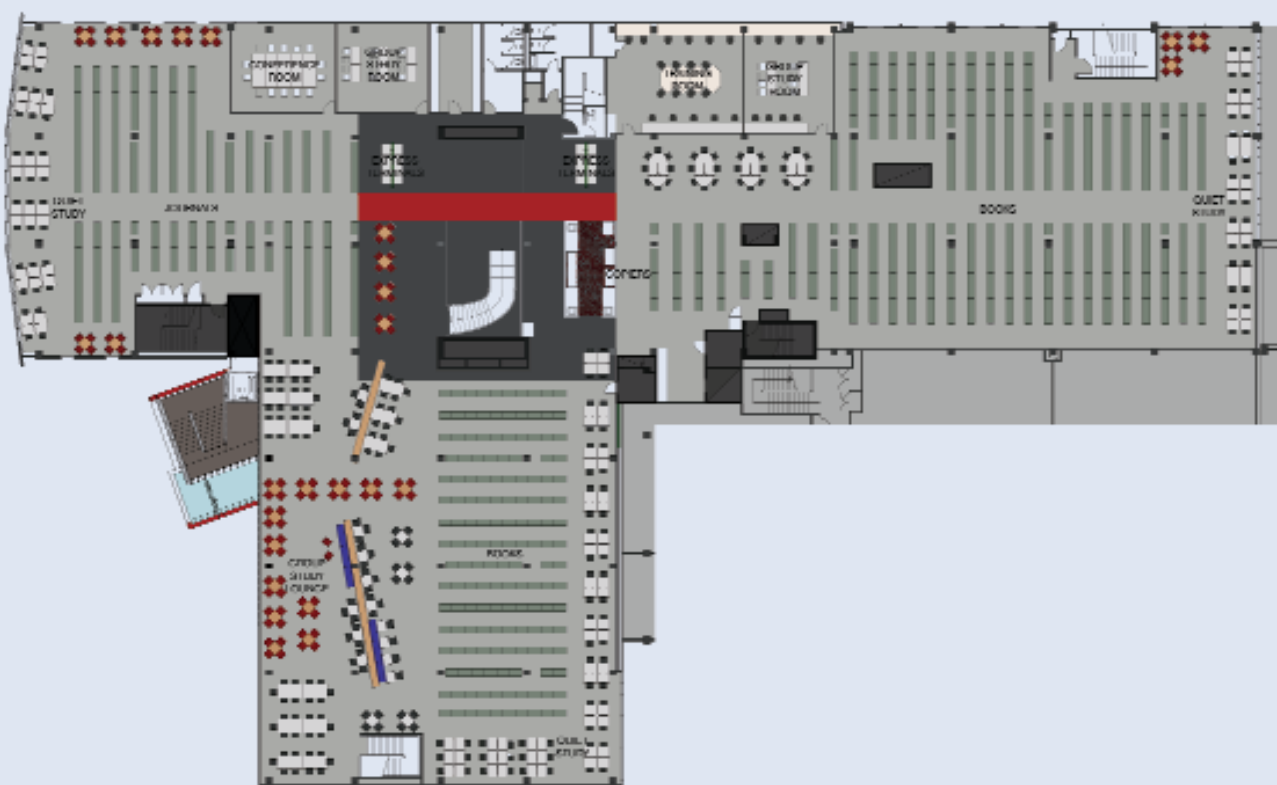

## Level Two

- Access to a wireless network plus power and data points for notebooks
- Multiple study areas to suit different needs and study styles, including casual seating
- Express terminals for accessing the library catalogue and resources
- Improved access to all areas of the collection
- New bridge for more convenient access between collections and facilities